

Simple Solutions FM

Simplifying Facilities Management and Maintenance

978-263-9911
www.simplesolutionsfm.com

Drawing Conversion

Services

Simple Solutions FM offers experienced, professional drawing scanning services. Using the latest tools and skilled personnel required we provide quality imaging services for all types of architectural and engineering drawings.

Scanning your historic building drawings and documentation provides safe and protected access to this information.

From Paper to 100% CAD Conversion

PRESERVE YOUR PAPER DRAWINGS...

- Not easily retrieved
- Not easily distributed
- Expensive to store, maintain, and distribute
- Deteriorates with age resulting in information loss

...SCAN THEM TO DIGITAL IMAGE...

- Stores up to 4,500 D-size (24" x 36") drawings on one CD
- Stores up to 32,000 D-size (24" x 36") drawings on one DVD
- Stops deterioration and improves quality of the drawing
- Is easily retrieved and distributed
- Back up copies can be stored safely, even offsite

...OR CONVERT THEM TO 100% AUTOCAD .DWG FILES...

- Confirmation to your CAD specifications
- Completely layered, dimensionally accurate, 100% CAD perfect
- No cleanup required

Resulting in:

- Cleaner drawings
- Better data analysis
- Easy drawing changes and updates
- Easy integration with CAFM systems

...AND THEN INTEGRATE THEM INTO CAFM

- Integrates graphic data with non graphic data
- CAD benefits without needing to know CAD
- Easy access to drawings and data

FROM PAPER...



TO DIGITAL FILE...

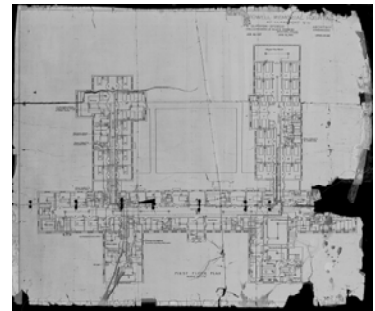

TO 100% CAD CONVERSION...



TO CAFM...



Contact us:
978-263-9911
info@simplesolutionsfm.com
www.simplesolutionsfm.com